



# APPLICATION INSTRUCTIONS

Turn your device off, and remove the battery if possible.



**WASH**

1. Wash your hands and fingertips thoroughly before beginning installation.



**PEEL**

2. Spray your fingertips with SHIELDSpray™ before handling the invisibleSHIELD™ to avoid putting fingerprints on it. Peel the invisibleSHIELD™ off its paper backing.



**HOLD**

3. Hold the invisibleSHIELD™ in your hand, adhesive side up.



**SPRAY**

4. Lightly spray the front and back sides of the invisibleSHIELD™ with SHIELDSpray™.

HINT: Spray the invisibleSHIELD™, NOT your device.

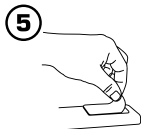

**APPLY**

5. Apply the invisibleSHIELD™ to your device, adhesive side down, and slide into place.

6



**SQUEEGEE**

6. Using the included squeegee (or any stiff plastic card), push the excess moisture and bubbles away from the center to the edges, and away from any open ports.

**HINTS:** For challenging tabs and flaps that wrap around or over the sides, we would recommend: (A) holding the tabs and flaps in place against the palm of your hand until they are secure, and (B) use a blow dryer on a low, **COOL** setting to dry the pieces. Letting these parts dry for a few minutes will make them tackier and easier to install.



**BLOW DRY**

For more information on the blow dryer method and other tips, please visit our website:

**[www.invisibleSHIELD.com/application](http://www.invisibleSHIELD.com/application)**

7



**TOWEL**

7. Soak up any excess moisture with a lint-free cloth or paper towel. Micro-bubbles and imperfections will work themselves out over 2-3 days.

**We recommend letting your device sit overnight before turning it back on (12-24 hours is suggested). This will give the invisibleSHIELD™ time to "set up" properly, and allow any remaining SHIELDSpray™ solution on your device to fully dry.**

Watch the pros! View an entire application process on our website: [www.invisibleSHIELD.com/application](http://www.invisibleSHIELD.com/application)